

# SPIACAR

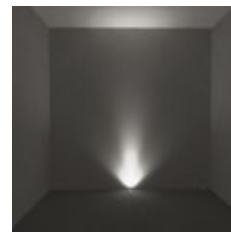

photo by: Germano Borrelli

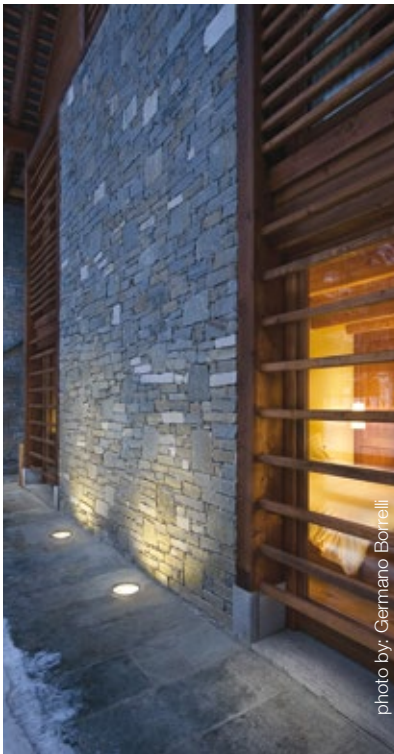

24°



80°

**.15** acciaio inox  
stainless steel

## ACCESSORI ACCESSORIES



**017**  
controcassa  
rough-in housing



**204**  
Connettore rapido IP68  
IP 68 fast connector



**279**  
Connettore per  
cablaggio in cascata IP 68  
IP 68 connector  
for through wiring

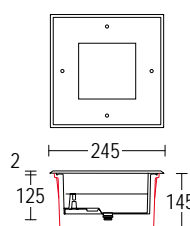
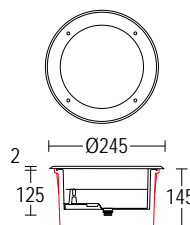

**5329.BRM.T.15** 12W LED 3000 K 1800lm  
24° ^  
220-240V 50/60hz  
alimentatore incluso *LED driver integral*

**5329.BUM.T.15** 18W LED 3000 K 2510lm  
24° ^  
220-240V 50/60hz  
alimentatore incluso *LED driver integrall*

**5329.147.A.15** 13W LED 3000 K 2040lm  
80° ^  
220-240V 50/60hz  
alimentatore incluso *LED driver integral*

**5323.BRM.T.15** 12W LED 3000 K 1800lm  
24° ^  
220-240V 50/60hz  
alimentatore incluso *LED driver integral*

**5323.BUM.T.15** 18W LED 3000 K 2510lm  
24° ^  
220-240V 50/60hz  
alimentatore incluso *LED driver integral*

**5323.147.A.15** 13W LED 3000 K 2040lm  
80° ^  
220-240V 50/60hz  
alimentatore incluso *LED driver integral*