

SEGNO FLAT RD

Apparecchio da incasso a pavimento, soffitto e parete. Grazie alle molteplici ottiche e potenze disponibili risulta estremamente versatile nel suo utilizzo. Ideale per illuminare facciate, colonne ed enfatizzare elementi architettonici.

Compact recessed fixture for ground, wall or ceiling application. Thanks to the wide range of optics and powers, it is extremely versatile in its use. It is designed to light passages, walkways, steps and staircases



photo by: Germano Borrelli

SEGNO FLAT RD

Disponibile versione 24V DC
24V DC version available

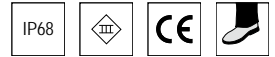

.15 acciaio inox
stainless steel

ACCESSORI ACCESSORIES



controcassa
rough-in housing
201 Microsegno flat
202 Segno flat
203 Maxisegno flat

Controcassa per prodotto
compatibile con alimentatore
Rough-in housing for product
compatible with LED driver

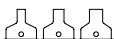

610 Microsegno flat
611 Segno flat
612 Maxisegno flat



620-IP67
Alimentatore 350mA SELV
1 per 1-10 Segno flat 1W
LED driver 350mA SELV
1 for 1-10 Segno flat 1W



204
Connettore rapido IP68
IP 68 fast connector



Adattatore per installazione
su scatola 503
Adaptor for installation like box 503

295 Microsegno flat
296 Segno flat
297 Maxisegno flat

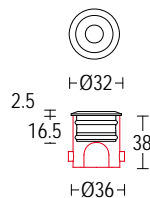

1117.I6F.B.15 1W LED 3000K 120lm
110° ^
max 350mA DC
alimentatore remoto SELV non incluso
remote SELV LED driver not included

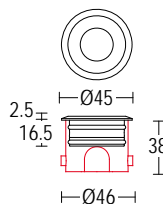

1118.I6F.B.15 1W LED 3000K 120lm
110° ^
max 350mA DC
alimentatore remoto SELV non incluso
remote SELV LED driver not included

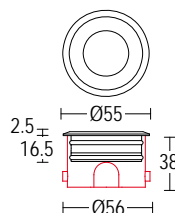

1119.I6F.B.15 1W LED 3000K 120lm
110° ^
max 350mA DC
alimentatore remoto SELV non incluso
remote SELV LED driver not included