

# MICROFARO / MINIFARO FLAT



Il proiettore Minifaro flat offre soluzioni architettoniche molteplici a lighting designers ed architetti. Design essenziale, ricchezza di accessori ed elevate performances ottiche ne completano le caratteristiche. L'ampia gamma di soluzioni LED disponibili risponde alle esigenze di risparmio energetico e riduzione dei costi di manutenzione.

*Minifaro floodlights offers a variety of architectural solutions to both lighting designers and architects. Main distinguish characteristics are pure design, wide range of accessories and high value optic systems. The range of powerful LEDs available meets different goals, both in terms of energy savings and cost reduction for maintenance.*

# MICROFARO / MINIFARO FLAT



16°

42°

- .05** grigio antracite  
*anthracite grey*
- .13** grigio chiaro  
*light grey*

## ACCESSORI ACCESSORIES



Schermo anti-abbagliamento  
*Louvre screen anti glare*

- 319** Microfaro flat
- 321** Minifaro flat



Cintura di sostegno  
*Support belt*

- 644** Microfaro flat
- 654** Minifaro flat



**203**  
Picchetto  
*Stake*



**204**  
Connettore rapido IP68  
*IP 68 fast connector*

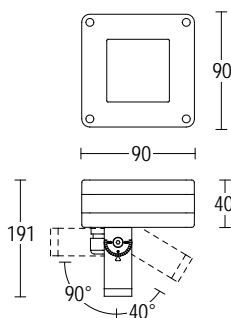

**1396.AHF.T.--** 8W LED 3000K 720lm  
29° ^  
220-240V 50/60hz  
alimentatore incluso *LED driver integral*

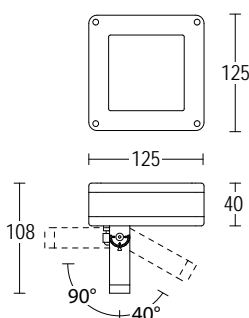

**1397.GZS.T.--** 15W LED 3000K 1425lm  
16° ^  
220-240V 50/60hz  
alimentatore incluso *LED driver integral*

**1397.GZF.T.--** 15W LED 3000K 1425lm  
42° ^  
220-240V 50/60hz  
alimentatore incluso *LED driver integral*

# MICROFARO / MINIFARO



Il proiettore Minifaro offre soluzioni architettoniche molteplici a lighting designers ed architetti. Design essenziale, ricchezza di accessori ed elevate performances ottiche ne completano le caratteristiche. L'ampia gamma di soluzioni LED disponibili risponde alle esigenze di risparmio energetico e riduzione dei costi di manutenzione.

*Minifaro floodlights offers a variety of architectural solutions to both lighting designers and architects. Main distinguish characteristics are pure design, wide range of accessories and high value optic systems. The range of powerful LEDs available meets different goals, both in terms of energy savings and cost reduction for maintenance.*



# MICROFARO / MINIFARO

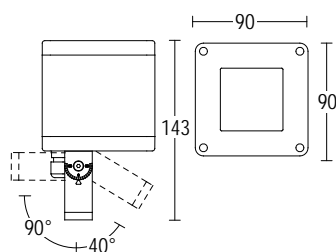

**1132.AHF.T.--** 7W LED 3000 K 1045lm  
 32° ^  
 220-240V 50/60hz  
 alimentatore incluso *LED driver integral*

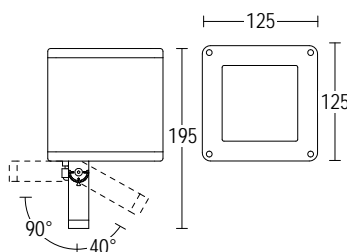

**1133.DGS.T.--** 16W LED 3000K 2270lm  
 14° ^  
 220-240V 50/60hz  
 alimentatore incluso *LED driver integral*

**1133.DGF.T.--** 16W LED 3000K 2270lm  
 35° ^  
 220-240V 50/60hz  
 alimentatore incluso *LED driver integral*

**1133.FNS.T.--** 29W LED 3000K 3870lm  
 14° ^  
 220-240V 50/60hz  
 alimentatore incluso *LED driver integral*

**1133.FNF.T.--** 29W LED 3000K 3870lm  
 35° ^  
 220-240V 50/60hz  
 alimentatore incluso *LED driver integral*

- .05 grigio antracite  
anthracite grey
- .13 grigio chiaro  
light grey

## ACCESSORI ACCESSORIES



Schermo anti-abbagliamento  
*Louvre screen anti glare*  
**319** Microfaro  
**321** Minifaro



Cintura di sostegno  
*Support belt*  
**644** Microfaro  
**654** Minifaro



**203**  
Picchetto  
*Stake*



**204**  
Connettore rapido IP68  
*IP 68 fast connector*

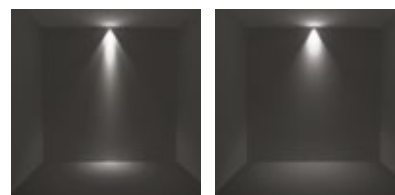

14°

35°