

LED-NOVA-CML

Ceiling Mounted Light



Quickinfo

GENERAL

ceiling mounted
with internal LED driver

LED

COB LED module
2700K, 3000K, 4000K
CRI > 80, CRI > 90
Bining < 3-Step MacAdam

ESTIMATED LED LIFETIME

L80 / 50,000h

OPTICAL

direct illumination
beam angle 18°, 30°, 45°

ELECTRICAL

non DIM

PHYSICAL

aluminium
powder coating

Function

Cylindrical surface mounted light made of aluminum.
Functional housing design with LED driver inside.
Optimized passive cooling system ensures low temperature and long lifetime of LED.

Interchangeable decoration ring for various lighting application.
Adopt of lens guarantees high luminous efficiency and uniform distribution.
Very easy to change lens (twist and lock) to choose spot, narrow and medium beam angle.

Features

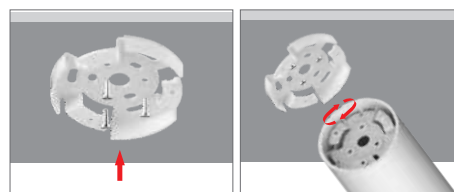

Ceiling installation plate fixed by screws
Twist and lock system between housing and ceiling installation plate

Order options

COLOUR TEMPERATURE

2700K
3000K
4000K

COLOUR RENDERING INDEX

CRI 80
CRI 90

HOUSING COLOUR



White

Black

LENS



18°Beam

30°Beam

45°Beam

REFLECTOR



Black

White

OPTIONAL ANTI-GLARE ACCESSORY



Honeycomb mesh
HM-M

LED-NOVA-CML

3000K
(Standard)

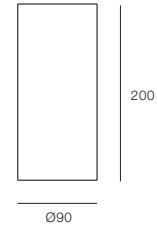

Light distribution for 3000K

28W 2700lm-2900lm

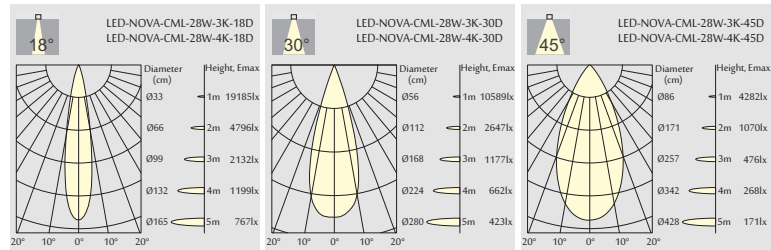

LED-NOVA-CML-28W-BLK BLACK MODELS

(CITIZEN LED)

Code	LED output	Module output	CD	LED Power	System Power	CRI	CCT	BEAM
LED-NOVA-CML-28W-BLK-30-18D	3400 lm	2700 lm	19194 cd	25 W	28 W	90	3000K	18°
LED-NOVA-CML-28W-BLK-40-18D	3600 lm	2900 lm	20012 cd	25 W	28 W	90	4000K	18°
LED-NOVA-CML-28W-BLK-30-30D	3400 lm	2700 lm	10662 cd	25 W	28 W	90	3000K	30°
LED-NOVA-CML-28W-BLK-40-30D	3600 lm	2900 lm	11854 cd	25 W	28 W	90	4000K	30°
LED-NOVA-CML-28W-BLK-30-45D	3400 lm	2700 lm	4285 cd	25 W	28 W	90	3000K	45°
LED-NOVA-CML-28W-BLK-40-45D	3600 lm	2900 lm	4588 cd	25 W	28 W	90	4000K	45°

LED-NOVA-CML-28W WHITE MODELS

(CITIZEN LED)

Code	LED output	Module output	CD	LED Power	System Power	CRI	CCT	BEAM
LED-NOVA-CML-28W-WH-30-18D	3400 lm	2700 lm	19194 cd	25 W	28 W	90	3000K	18°
LED-NOVA-CML-28W-WH-40-18D	3600 lm	2900 lm	20012 cd	25 W	28 W	90	4000K	18°
LED-NOVA-CML-28W-WH-30-30D	3400 lm	2700 lm	10662 cd	25 W	28 W	90	3000K	30°
LED-NOVA-CML-28W-WH-40-30D	3600 lm	2900 lm	11854 cd	25 W	28 W	90	4000K	30°
LED-NOVA-CML-28W-WH-30-45D	3400 lm	2700 lm	4285 cd	25 W	28 W	90	3000K	45°
LED-NOVA-CML-28W-WH-40-45D	3600 lm	2900 lm	4588 cd	25 W	28 W	90	4000K	45°

Item No	Product Code	Description
08210	NOVA-CML-28W-BLK-3K	NOVA-CML - black housing non dim HEP driver 28W 2700Lm 90CRI Citizen chip - 3K Warm white
08211	NOVA-CML-28W-BLK-4K	NOVA-CML - black housing non dim HEP driver 28W 2900Lm 90CRI Citizen chip - 4K Neutral white
08212	NOVA-CML-28W-WH-3K	NOVA-CML - white housing non dim HEP driver 28W 2700Lm 90CRI Citizen chip - 3K Warm white
08213	NOVA-CML-28W-WH-4K	NOVA-CML - white housing non dim HEP driver 28W 2900Lm 90CRI Citizen chip - 4K Neutral white
08214	NOVA-CML-R-BLK	NOVA-CML - Black reflector
08215	NOVA-CML-R-WH	NOVA-CML - White reflector
08216	NOVA-CML-HC	NOVA-CML - Honey comb mesh
08217	NOVA-CML-LENS-18	NOVA-CML - 18 degree lens
08218	NOVA-CML-LENS-30	NOVA-CML - 30 degree lens
08219	NOVA-CML-LENS-45	NOVA-CML - 45 degree lens